

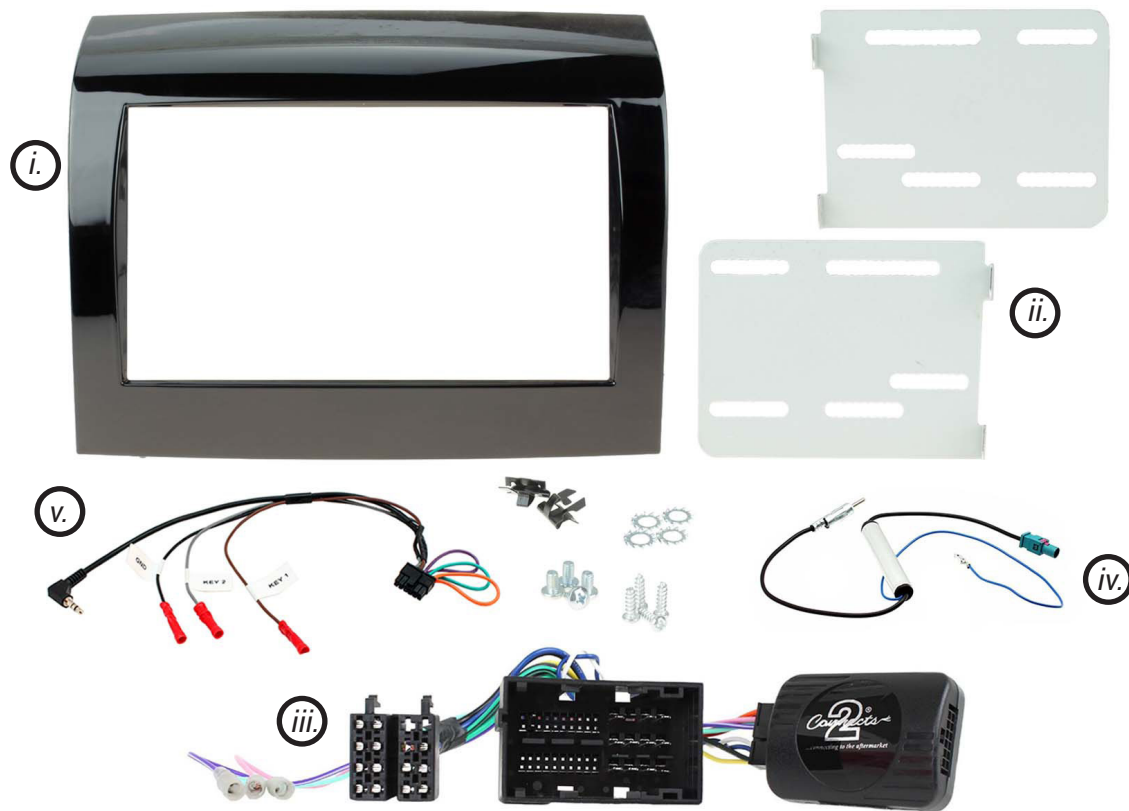

CTKFT14

## Complete Installation Kit for Fiat vehicles



### IN THE KIT

- |      |                             |     |                      |
|------|-----------------------------|-----|----------------------|
| i.   | Double DIN Fascia           | iv. | Antenna Adapter      |
| ii.  | Brackets & Accessories      | v.  | Universal Patch Lead |
| iii. | Vehicle Interface & Harness |     |                      |

Designed and  
Engineered  
in the UK. 

### APPLICATION

Note: Application data is subject to change at any time

Fiat Ducato (X290)

2015 - 2021

Please Note: this kit is for facelift models only. Vehicle will need modification, familiarise yourself with instructions before installation.

### FEATURES

- Allows for the installation of a double DIN aftermarket stereo
- Comes complete with accessories for fitment of double DIN stereo
- Retains steering wheel control & phone button functionality
- Provides outputs for park brake, reverse gear and speed pulse
- Includes additional accessories including antenna adapter and patch lead
- Finished in black to match the vehicles dashboard

#### DISCLAIMER

The information provided in this document is subject to change without notice due to manufacturer changes and/or improvements to the product/s. This instruction manual is based on documented data and research. The manufacturer of this product cannot be held responsible for any changes made to the vehicle by the manufacturer or damages that may occur through the installation of this product in accordance with the steps outlined herein.

# PRODUCT INFORMATION

The **CTKFT14** is a complete installation kit that allows for the fitment of an aftermarket head unit into the OEM dashboard of Fiat Ducato (X290) vehicles. The interface provided helps retain steering wheel control presets and phone button functionality (*if applicable*). The lead features plug-and-play connectors for an easier installation process.

Also provided is an antenna adapter, and a universal patch lead, to ensure compatibility with almost any head unit on the market.

**Note: this kit is intended for facelift models only.**

## WIRING KEY

### IN ISO CONNECTOR

Purple	Right Rear Speaker +	Yellow	Permanent 12V
Purple/Black	Right Rear Speaker -	Black	Ground
Green	Left Rear Speaker +	Red	Ignition 12V
Green/Black	Left Rear Speaker -	Orange	Illumination
Grey	Right Front Speaker +		
Grey/Black	Right Front Speaker -		
White	Left Front Speaker +		
White/Black	Left Front Speaker -		

### ADDITIONAL CONNECTIONS

Pink	Speed Pulse
Green	Park Brake
Purple/White	Reverse Gear

## STEERING WHEEL CONTROL FUNCTIONALITY

*The following diagram, though based on careful research, is an example only. Individual steering wheel control configurations may differ.*

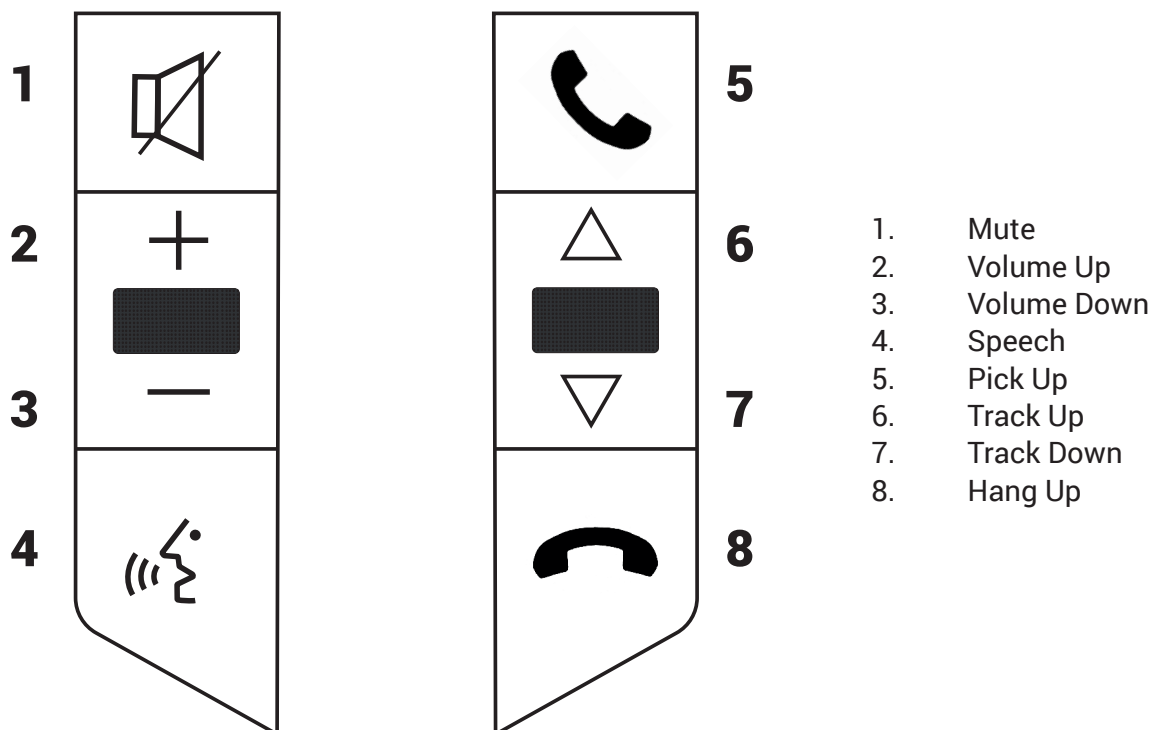

Need help? Visit [support.connects2.com/tickets/technical](https://support.connects2.com/tickets/technical)

# FASCIA DIAGRAM

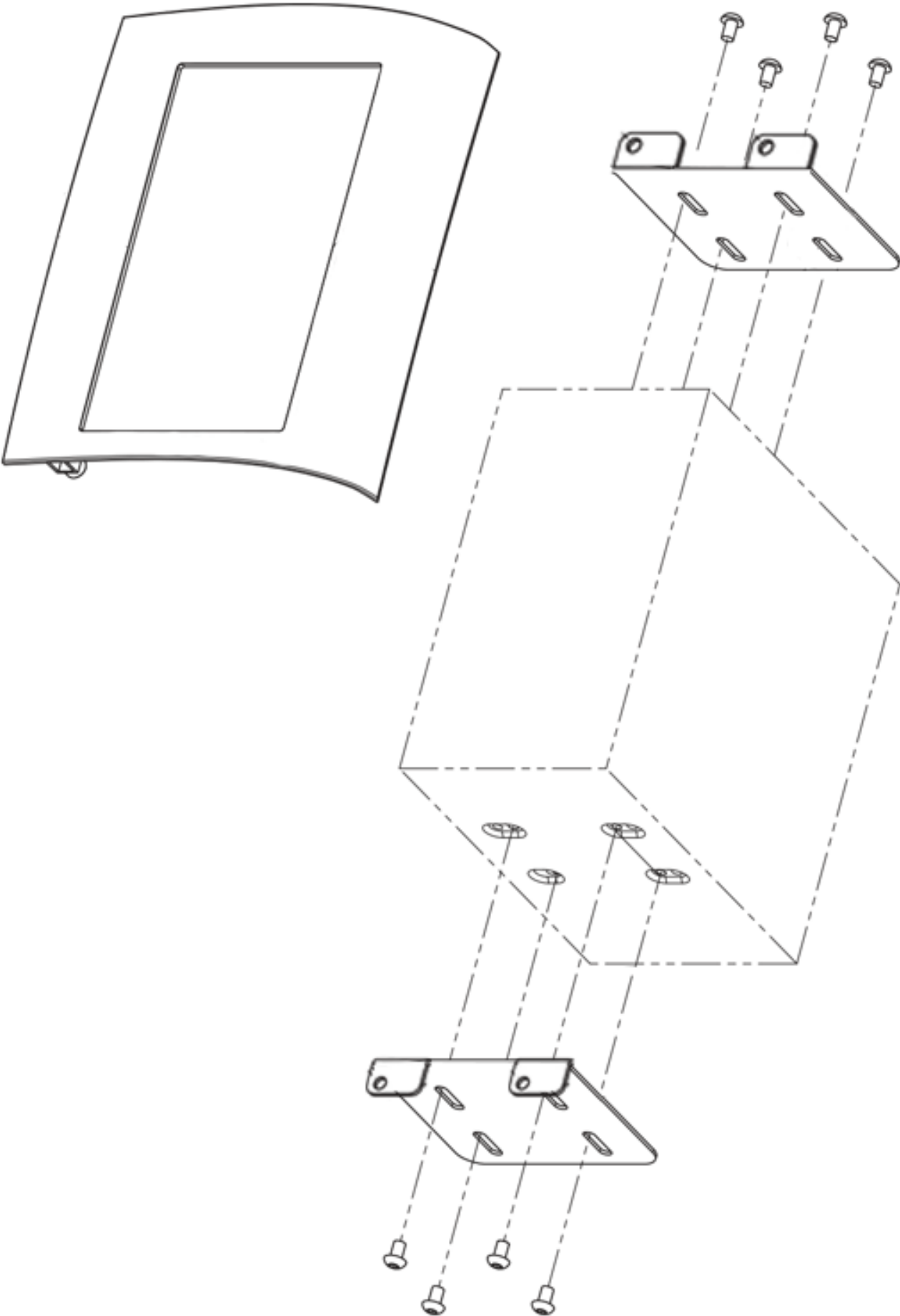

# WIRING DIAGRAM

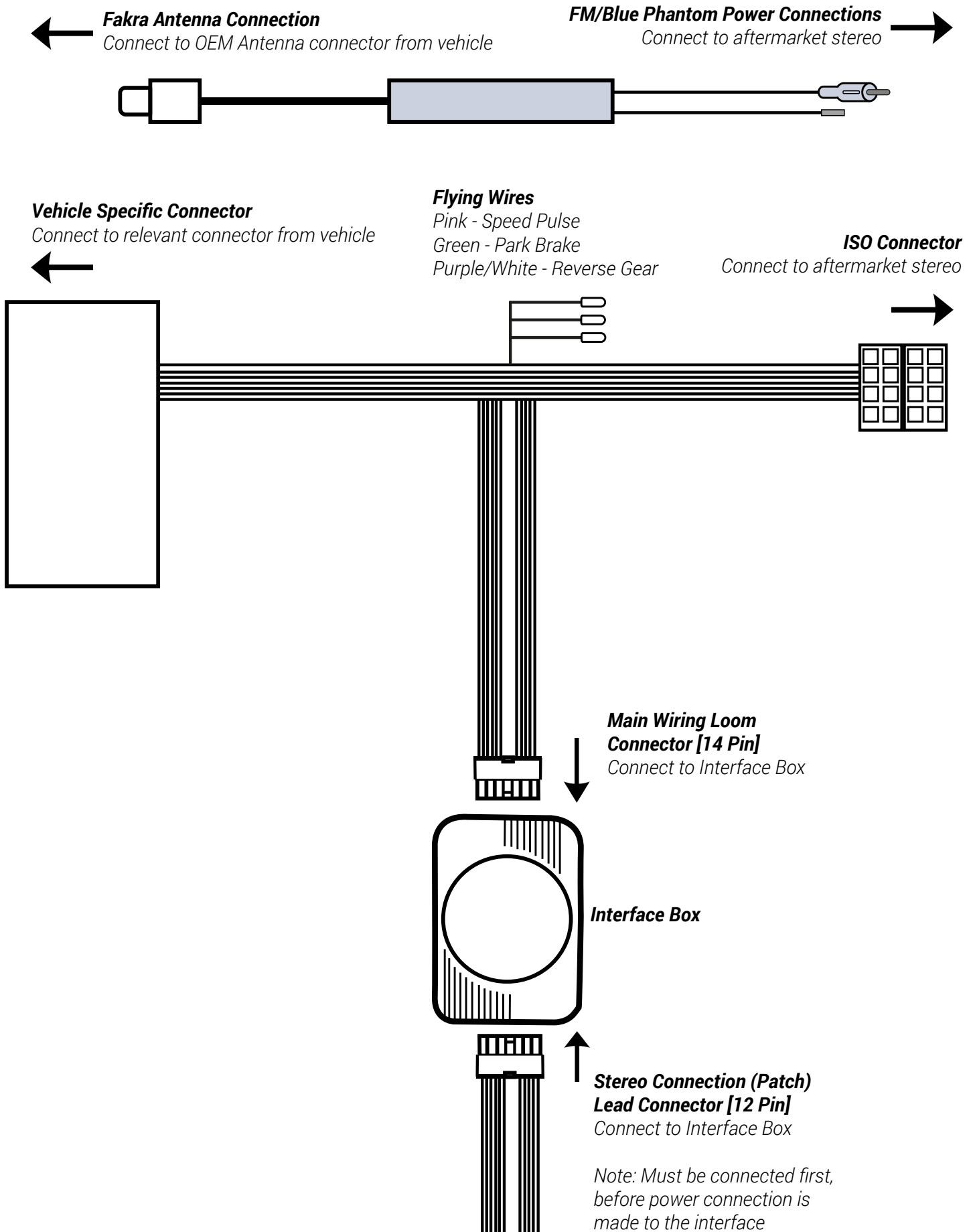

Need help? Visit [support.connects2.com/tickets/technical](https://support.connects2.com/tickets/technical)

# PRIOR TO INSTALLATION

Read the manual prior to installation. Technical knowledge is necessary for installation. The place of installation must be free of moisture and away from heat sources. Please ensure that the correct tools are used during the installation to avoid damage to the vehicle or product. **Connects2 can not be held responsible for the installation of this product.**

## INSTALLATION GUIDE - FASCIA

### DASH DISASSEMBLY

1.



Use a set of release keys to pry the head unit out of the dashboard. Dependent on the style of unit you have installed, you will need either single or double DIN keys. Once released, take out the unit and disconnect all the wiring.

2.

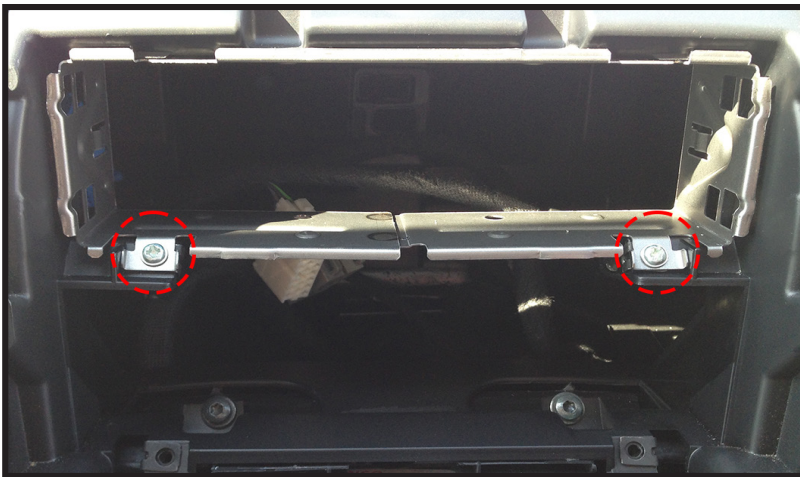

Once the main head unit is out of the way, proceed to remove the highlighted screws. When done, proceed to fully remove the cage.

### DASH MODIFICATION

3.



The highlighted area(s) on the inner dash will need to be cut out in order to allow the new double DIN unit to sit correctly.

*When performing any modification to the vehicle, always ensure to measure where the stereo will sit and take due care when performing cuts to the vehicle. Connects2 always promotes the use and expertise of professional installers. Connects2 will not be held responsible for any damage to the vehicle.*



# INSTALLATION GUIDE - FASCIA

## FASCIA ASSEMBLY

4.

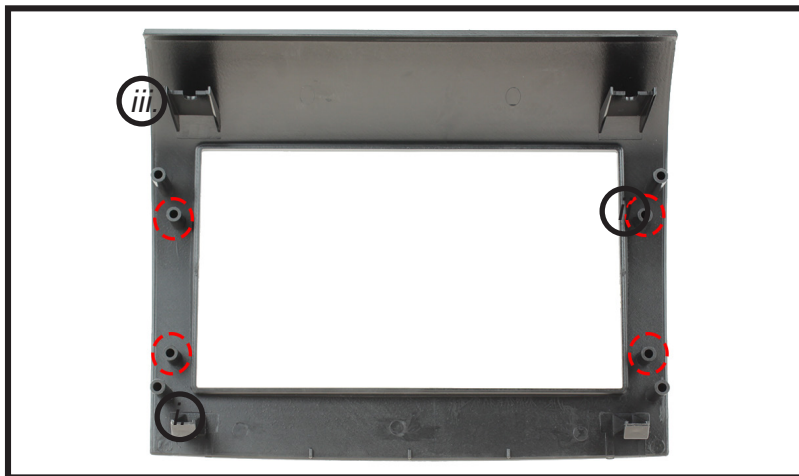

Using the 4x phillips screws, take the brackets and line them up to the following posts on the rear of the new fascia panel and proceed to attach them to the relevant side.

5.



Once the brackets are fixed to the fascia, take the new stereo and slide it in the back toward the opening. Lining the stereo up correctly, use the screws/washers within the kit to attach it according to the correct depth.

## DASH ASSEMBLY

6.



Once the kit has been assembled and the wiring for the stereo is completed, simply use the clips within the kit on the reverse of the fascia and proceed to clip it into place.

# SETTING DIPSWITCHES

Prior to installation, the circuit board dipswitches must be set to ensure correct operation of the product. To do this, remove the interface box casing and set the dipswitches as follows:

**Dipswitch 1 - Set to 'ON' for vehicles with 250VP1 factory stereo, otherwise set to 'OFF'**

**Dipswitch 2 - Set to 'ON' for vehicles with 250VP2 factory stereo, otherwise set to 'OFF'**

**Dipswitch 3 - Set to 'ON' for vehicles with factory Blue&Me system, otherwise set to 'OFF'**

**Dipswitch 4 - Set to 'ON' if installing a Pioneer stereo. Set to 'OFF' if installing a Sony stereo.**

*NB: Only change dipswitch positions when interface is disconnected from the vehicle.*

## INSTALLATION GUIDE - WIRING

*See Wiring Diagram on Pg.4 for more information*

Before installing the interface, the factory stereo must be removed and disconnected. To do this, please consult the vehicle owner's manual/handbook or contact a fitting professional.

For universal patch leads, prepare the wiring loops in accordance with the instruction manual supplied before installation.

1. Connect the 12 Pin connector from the stereo connection (patch) lead to the interface box.
2. Connect the opposite end of the stereo connection (patch) lead to the steering wheel control input on the back of the aftermarket stereo.

*NOTE: This may be a 3.5mm jack connector or a wired input depending on the brand of aftermarket stereo being fitted. Please consult the aftermarket stereo installation manual for further information on where to make the connection.*

**! IMPORTANT: THIS STEP MUST BE COMPLETED BEFORE CONNECTING POWER TO THE INTERFACE. FAILURE TO DO SO MAY RESULT IN A LACK OF FUNCTIONALITY AND THE NEED TO REINSTALL THE PRODUCT**

3. Connect the 14 Pin connector from the supplied wiring loom to the interface box.
4. Connect the power/speaker ISO connector to the power/speaker ISO connector at the rear of aftermarket stereo.

*Note: For aftermarket stereos which do not have an ISO connector, please see 'Wiring Key' on Pg.2 for information on which wires to connect.*

5. Connect any additional flying wires from the harness to the head unit as required.

*Note: Additional 'flying' wires can be connected to the vehicle to support various features i.e. parking brake trigger, reverse gear and speed pulse. Details of these can be found under 'Additional Connections'.*

6. Connect the vehicle specific connector on the supplied harness to the OEM connector from the vehicle.
7. Attach the antenna adapter in between the vehicles pre-existing connector as well as the rear of the aftermarket head unit.

**NOTE: If vehicles which feature an amplified aerial, the blue wire will be needed for purposes of phantom power.**

8. Test stereo and steering wheel control functionality for correct operation before reassembling the vehicle dashboard. If steering wheel control functions are unresponsive, please uninstall the interface and wiring and reinstall carefully in accordance with the above steps.

*For further help, please contact and fill out a support ticket with the full details of your issue at:  
**[support.connects2.com/tickets/technical](https://support.connects2.com/tickets/technical)***

# NOTES

---